

CONTRACT HY/2009/15

CENTRAL – WAN CHAI BYPASS
TUNNEL (CAUSEWAY BAY TYPHOON SHELTER SECTION)

Landscape Plan

Submission Status: For Approval

Revision	Description	Date
0	1 st Submission	17 February 2011

Prepared by:	Kelven Yip		17/02/2011
	Environmental Supervisor	Signature	Date
Checked by:	Anna Yu		17/02/2011
	Environmental Officer	Signature	Date
Approved by:	K. Y. Leung		17/02/2011
	Contractor's Representative	Signature	Date

Ref.: AACWBIECEM00_0_0995L.11

17 February 2011

By Post and Fax (2566 2192)

China State Construction Engineering (Hong Kong) Ltd.
29/F, China Overseas Building
139 Hennessy Road
Hong Kong

Attention: Mr. K. Y. Leung

Dear Sir,

**Re: Contract No. HY/2009/15
Central – Wan Chai Bypass – Tunnel (Causeway Bay Typhoon Shelter
Section)
Landscape Plan (Revision 0)**

Reference is made to your submission of the Landscape Plan (Revision 0 dated 17 February 2011) to us through E-mail on 17 February 2011 for our review and comment.

Please be informed that we have no further comments on the captioned submission. We write to verify the captioned submission in accordance with Condition 2.21 of FEP-04/356/2009.

Thank you for your kind attention.

Yours sincerely,



David Yeung
Independent Environmental Checker

c.c.	HyD	Mr. Jones Lai	by fax: 2714 5289
	CEDD	Mr. Patrick Keung	by fax: 2577 5040
	AECOM (CWB)	Mr. Peter Poon	by fax: 3529 2829
	AECOM	Mr. Kelvin Cheng	by fax: 2691 2649
	LAM	Mr. Raymond Dai (ETL)	by fax: 2882 3331

Q:\Projects\AACWBIECEM00\Corr\AACWBIECEM00_0_0995L.11.doc



Lam Geotechnics Limited

Ground Investigation & Instrumentation Professionals

華益土力有限公司

Ref : G1001/CS/L288/FEP-04/356/2009
Date : 17 February 2011

China State Construction Engineering (Hong Kong) Ltd.
29/F, China Overseas Building,
139 Hennessy Road, Hong Kong

Attn: Mr. K. Y. Leung

Dear Sir,

FEP-04/356/2009
Contract No. HY/2009/15
Central- Wan Chi Bypass – Tunnel (Causeway Bay Typhoon Shelter Section)
Landscape Plan (Revision 0)

Referring to your submission of the captioned plan (Revision 0 dated 17 February 2011) received through email on 17 February 2011, we have reviewed your submitted details and hereby certify this submission in accordance with Condition 2.21 of Further Environmental Permit no. FEP-04/356/2009.

Should you have any enquiry, please feel free to contact the undersigned at 2839 5666.

Yours faithfully,

Raymond Dai
Environmental Team Leader

c.c. CEDD
HyD
AECOM CWB
AECOM WDII
ENVIRON

- Mr. Patrick Keung
- Mr. Jones Lai
- Mr. Peter Poon
- Mr. Frankie Fan
- Mr. David Yeung

(By Fax: 2577 5040)
(By Fax 2714 5289)
(By Fax: 3529 2829)
(By Fax: 2587 1877)
(By Fax: 3548 6988)





LIST OF CONTENT

- 1.0 Introduction
- 2.0 Landscape Mitigation Measures
- 3.0 Identified Visual Sensitive Receivers
- 4.0 Sources of Night-time Lighting Impacts
- 5.0 Control of Night-time Lighting
- 6.0 On Site Supervision
- 7.0 Implementation Programme, Maintenance and Management Schedule

APPENDICES

- Appendix A Site Layout Plan
- Appendix B Location Plan of Visual Sensitive Receivers

1.0 Introduction

The purpose of this plan is to demonstrate design details, locations, implementation programme, maintenance and management schedules in accordance with contract requirement, Condition 2.24 of Environmental Permit No. EP-356/2009 and Condition 2.21 of Further Environmental Permit No. FEP-04/356/2009.

2.0 Landscape Mitigation Measures

The proposed landscape mitigation measure during construction phase for HY/2009/15, but not limited to, is listed as below:

- a. Control of night-time lighting

3.0 Identified Visual Sensitive Receivers

The following visual sensitive receivers (VSRs) are likely to be affected during the construction phase of this project:

- C/R4 (Elizabeth House);
- C/R5 (Riviera Mansion);
- C/R6 (Prospect Mansion);
- C/R7 (Miami Mansion);
- C/R8 (Marco Polo Mansion);
- C/R9 (Victoria Park Mansion);
- C/R18 (Belle House);
- C32 (Excelsior Hotel);
- C36 (Citicorp Centre); and
- C37 (Victoria Centre).

The above VSRs are mapped in Appendix B.

4.0 Sources of Night-time Lighting Impacts

Sources of night-time lighting impacts during construction phase would include:

- Site investigations;
- Dredging and reclamation works;
- Construction of seawalls;

- Construction site traffic;
- Wind-solar powered pole lighting or other lighting devices at site offices;
- ¹Signal sensor light on yellow marker buoys which are laid to mark the position of the anchors extending from the working vessels; and
- ²Signal sensor light which are laid to mark the extent of the silt curtain.

5.0 Control of Night-time Lighting

The following measures, but not limited to, would be implemented where practical to minimize impact:

- a. Carefully planning of any night-time work would be adopted to minimize the use of unnatural lighting;
- b. The need of using lighting devices would be carefully assessed based on work task to minimize usage;
- c. Where lighting devices are needed to be operated, the devices would be aimed away from the visual sensitive receivers where necessary.
- d. For all floodlights mounted on the dredger (grab), the direction of light would be oriented to open sea and barge where possible.
- e. Signal sensor light would be attached on buoys and silt curtain only for the purpose of ensuring safe navigation.
- f. Wind-solar powered lighting pole or site office lighting will be oriented away from VSRs.

6.0 On Site Supervision of Night-time Lighting

The lighting impact will be monitored and assessed by designated person during night-time construction work. Upon any public concerns or complaints, the lights will be repositioned or shielded where necessary.

¹ Referring to Marine Department Notice No. 157, 176, 179 & 192 of 2010

² Ditto.



7.0 Implementation Programme, Maintenance and Management Schedule

Implementation Programme

Mitigation Measures	Location / Period
Control of night time lighting	Entire works area and construction phase involving marine works (Tentative schedule: 3 Dec 2010 to 20 Aug 2015)

Maintenance and Management Schedule

Maintenance and Management Schedule
Floodlights shall be checked every night to ensure that they are controlled to divert from sensitive receivers where practical.



Appendix A

Site Layout Plan

Point	HK 1980 Grid Coordinate		WGS 84 (Deg°MM'SS.S")		Point	HK 1980 Grid Coordinate		WGS 84 (Deg°MM'SS.S")	
	Northing(m)	Easting(m)	Latitude(N)	Longitude(E)		Northing(m)	Easting(m)	Latitude(N)	Longitude(E)
1	816123.163	836627.778	22° 17' 2.4"	114° 10' 49.3"	17	816318.982	837600.533	22° 17' 8.7"	114° 11' 23.3"
2	816158.294	836672.793	22° 17' 3.5"	114° 10' 50.9"	18	816248.756	837588.973	22° 17' 6.5"	114° 11' 22.9"
3	816183.090	836737.200	22° 17' 4.3"	114° 10' 53.1"	19	816147.576	837248.874	22° 17' 3.2"	114° 11' 11.0"
4	816233.339	836944.955	22° 17' 6.0"	114° 11' 0.4"	20	816044.312	837091.645	22° 16' 59.8"	114° 11' 5.5"
5	816297.883	836893.247	22° 17' 8.1"	114° 10' 58.6"	21	815941.724	836945.745	22° 16' 56.5"	114° 11' 0.4"
6	816321.616	836885.404	22° 17' 8.8"	114° 10' 58.3"	22	815931.125	836905.152	22° 16' 56.1"	114° 10' 59.0"
7	816424.234	837243.006	22° 17' 12.2"	114° 11' 10.8"	23	815961.289	836893.217	22° 16' 57.1"	114° 10' 58.6"
8	816515.377	837333.839	22° 17' 15.1"	114° 11' 14.0"	24	815960.075	836824.609	22° 16' 57.1"	114° 10' 56.2"
9	816550.091	837282.247	22° 17' 16.3"	114° 11' 12.2"	25	815959.749	836799.530	22° 16' 57.1"	114° 10' 55.3"
10	816648.248	837348.530	22° 17' 19.4"	114° 11' 14.5"	26	815994.733	836766.563	22° 16' 58.2"	114° 10' 54.2"
11	816579.824	837450.429	22° 17' 17.2"	114° 11' 18.1"	27	815931.497	836622.837	22° 16' 56.1"	114° 10' 49.1"
12	816625.456	837490.089	22° 17' 18.7"	114° 11' 19.4"	28	815976.887	836606.580	22° 16' 57.6"	114° 10' 48.6"
13	816587.845	837535.332	22° 17' 17.5"	114° 11' 21.0"	29	815973.209	836587.866	22° 16' 57.5"	114° 10' 47.9"
14	816525.608	837481.240	22° 17' 15.5"	114° 11' 19.1"	30	816058.039	836571.193	22° 17' 0.3"	114° 10' 47.3"
15	816489.139	837520.385	22° 17' 14.3"	114° 11' 20.5"	31	816063.332	836598.132	22° 17' 0.4"	114° 10' 48.3"
16	816386.319	837595.553	22° 17' 10.9"	114° 11' 23.1"	32	816102.525	836645.064	22° 17' 1.7"	114° 10' 49.9"

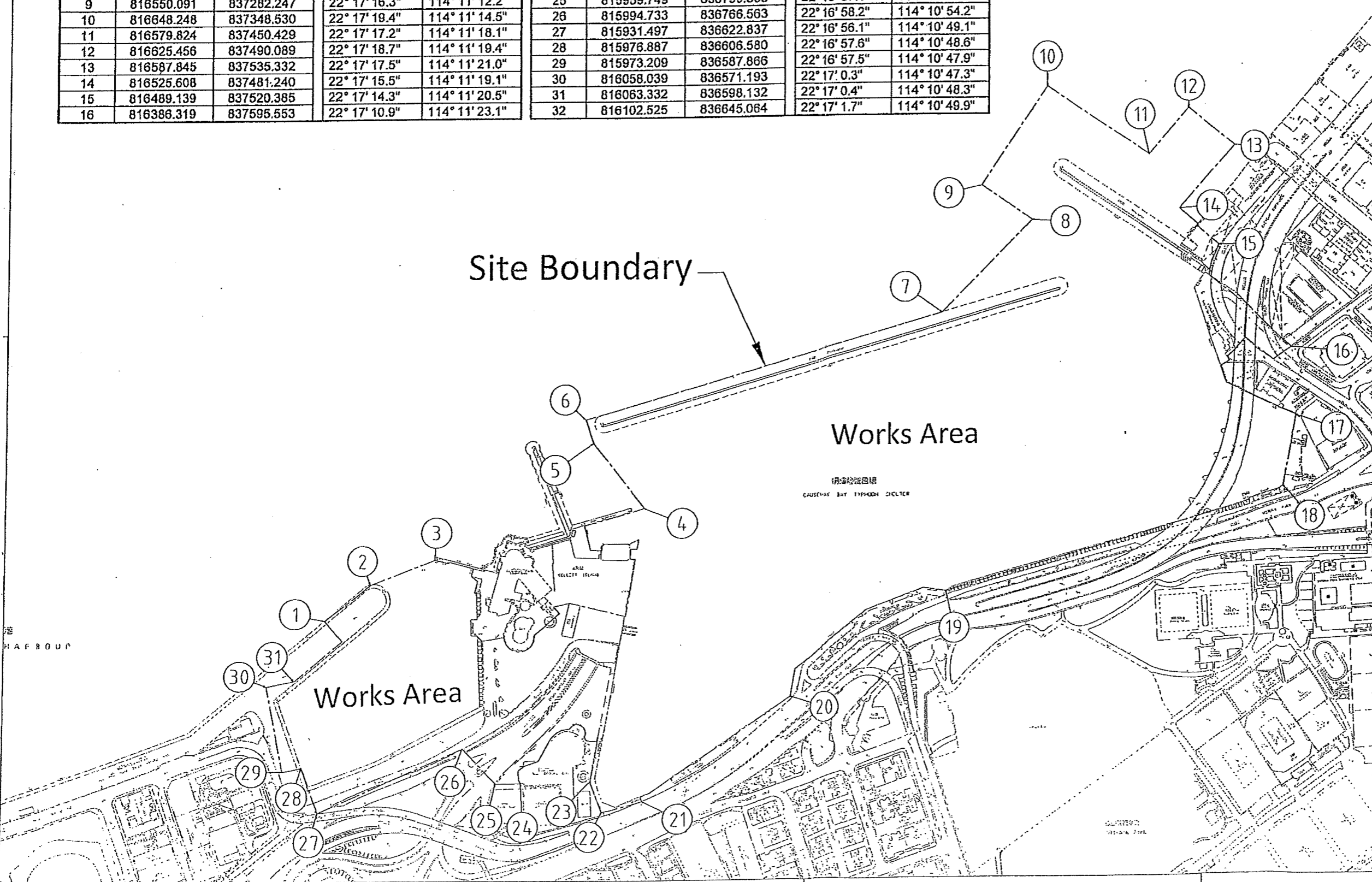

路政署
HIGHWAYS DEPARTMENT
主要工程管理處
Major Works Project Management Office

CENTRAL - WAN CHAI BYPASS
AND IEC LINK

TITLE
General Layout Plan

AECOM
AECOM Asia Co. Ltd.
(Formerly known as Mousset Consultants Asia Ltd.)

中國建築工程(香港)有限公司
CHINA STATE CONSTRUCTION ENG'G. (HONG KONG) LTD.

DRG. NO.
圖號
CWB/MN/SK-001

CONTRACT NO.
合約編號
HY/2009/15

DATE OF ISSUE
發出日期
21-09-2010

CHECKED BY
校核
KYCHAN

DRAWN BY
繪圖
KCCHUNG

SCALE
比例
1:4000

DIMENSIONS ARE IN
單位尺寸
METRES

PAPER SIZE
圖紙尺寸
A3



Appendix B

Location Plan of Visual Sensitive Receivers

KEY FOR VISUAL SENSITIVE RECEIVERS

- C1 International Finance Centre
- C2 Hong Kong Station Development Phase 2
- C3 Exchange Square
- C4 Jardine House
- C5 Mandarin Hotel
- C6 Hong Kong Club
- C7 Ritz Carlton Hotel
- C8 AIA Tower
- C9 Hutchison House
- C10 Bank of America Tower
- C11 Far East Financial Centre
- C12 Admiralty Centre
- C13 United Centre
- C14 CITIC Tower
- C15 Fleet Arcade
- C16 Asian House
- C17 Chung Nam Building
- C18 Fleet House, Harcourt House
- C19 Telecom House, Hong Kong Arts Centre, Harbour View International House
- C20 Shui On Centre
- C21 Central Plaza
- C22 Grand Hyatt Hotel
- C23 Renaissance Harbour View Hotel
- C24 Hong Kong Convention and Exhibition Centre
- C25 Great Eagle Centre
- C26 Harbour Centre
- C27 China Resources Building
- C28 Sun Hung Kai Centre
- C29 AXA Centre
- C30 Sino Plaza
- C31 World Trade Centre
- C32 Excelsior Hotel
- C33 The Park Lane Hotel
- C34 Windsor House
- C35 19-31 Yee Wo Street
- C36 Citicorp Centre
- C37 Victoria Centre
- C38 Ocean Terminal
- C39 Star House
- C40 Peninsula Hotel
- C41 Sheraton Hotel
- C42 InterContinental Hotel
- C43 New World Centre and Hotel
- C44 Wing On Plaza
- C45 Shangri-La Hotel
- C46 Tsim Sha Tsui Centre
- C47 Empire Centre
- C48 Grand Stanford Harbour View Hotel
- C49 Nikko Hotel
- C50 Four Season Hotel
- C51 Harbour Plaza Metropolis
- C52 AIA Tower
- C53 Newton Hotel
- C54 Electric Centre
- C54A Sea View Estate

- C/R1 Causeway Centre
- C/R2 160-168 Gloucester Road
- C/R3 210-226 Gloucester Road
- C/R4 Elizabeth House
- C/R5 Riviera Mansion
- C/R6 Prospect Mansion
- C/R7 Miami Mansion
- C/R8 Marco Polo Mansion
- C/R9 Victoria Park Mansion
- C/R10 Chestnutfield Mansion
- C/R11 Greenfield Mansion
- C/R12 Properties fronting Causeway Road
- C/R13 Park Towers
- C/R14 Viking Garden
- C/R15 50-52 Hing Fat Street
- C/R16 Mayson Garden Building
- C/R17 Gordon House
- C/R18 Belle House
- C/R19 Top Glory Tower
- C/R20 Hoi Kung Court
- C/R21 Hoi To Court
- C/R22 Hoi Deen Court
- C/R23 Pacific Place Complex

- GIC1 General Post Office
- GIC2 City Hall
- GIC3 PLA Headquarters at Tamar
- GIC4 Hong Kong Police Force Headquarters, May House
- GIC5 Revenue Tower
- GIC6 Wan Chai Tower
- GIC7 Police Officers' Club
- GIC8 Queen's College
- GIC9 Hing Fat Street Post Office
- GIC10 Victoria Park School for the Deaf
- GIC11 YMCA
- GIC12 Electric Road Municipal Services Building
- O1 Fenwick Pier Street Public Open Space
- O2 HKCEC Open Space
- O3 HKCEC Extension Open Space and Promenade
- O4 Renaissance Harbour View Plaza
- O5 Central Plaza Open Space
- O6 Wanchai Sports Ground
- O7 Tunnel Approach Rest Garden
- O8 Victoria Park
- O9 Tsim Sha Tsui Waterfront Promenade
- OU1 Royal Hong Kong Yacht Club

- R1 Residential Properties fronting Tung Lo Wan Road
- R4 Harbour Heights
- R5 Residential Properties fronting King Wah Road
- R6 City Garden
- R7 Provident Centre
- S1 Harbour Traffic
- T1 Wanchai North Road Network - vehicular - pedestrian
- T2 Gloucester Road Corridor - vehicular - pedestrian
- T3 Island Eastern Corridor

LEGEND

- PLANNING AND ENGINEERING REVIEW STUDY AREA BOUNDARY
- - - LIMIT OF PRIMARY ZONE OF VISUAL INFLUENCE
- C1 BOUNDARY OF KEY VSRs
- C01 PHOTO TAKING POINT WITH PHOTO NO.
- COMMERCIAL
- COMMERCIAL / RESIDENTIAL
- RESIDENTIAL
- RECREATIONAL
- GOVERNMENT / INSTITUTION / COMMUNITY
- TRANSPORT
- DP1 CENTRAL-WANCHAI BYPASS (CWB) INCLUDING ITS ROAD TUNNEL AND SLIP ROADS
- DP2 ROAD P2 AND OTHER ROADS WHICH ARE CLASSIFIED AS PRIMARY/DISTRICT DISTRIBUTOR ROADS
- DP3 RECLAMATION WORKS INCLUDING ASSOCIATED DREDGING WORKS
- DP4 TEMPORARY TYPHOON SHELTER

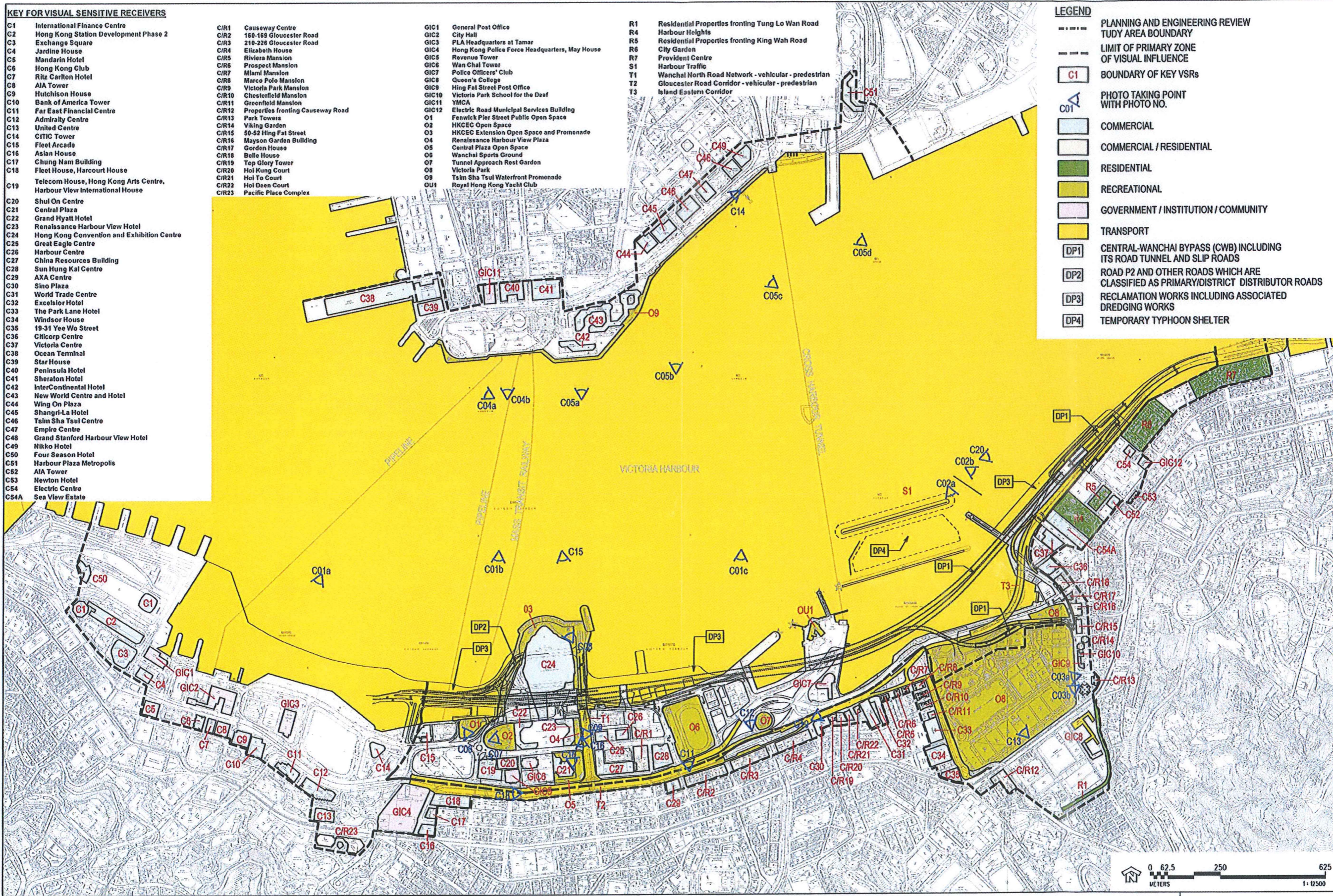

FILE : d:\wanchai\CON\FIGURE 10.4.dgn